

# BELLA PREMIER LEVEL AND STAIR RAIL DETAILS

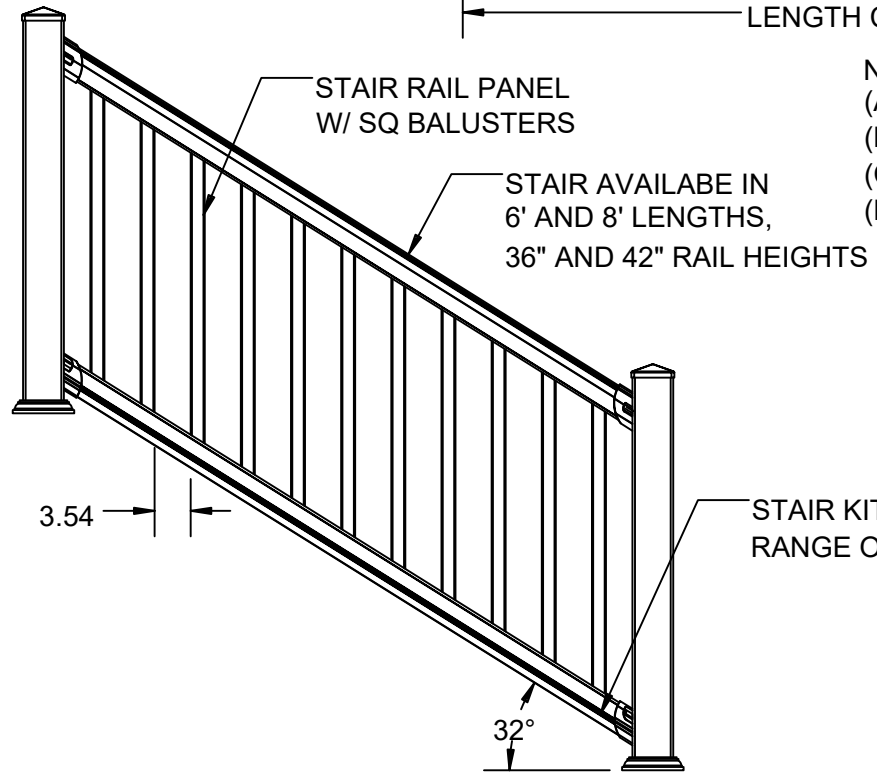
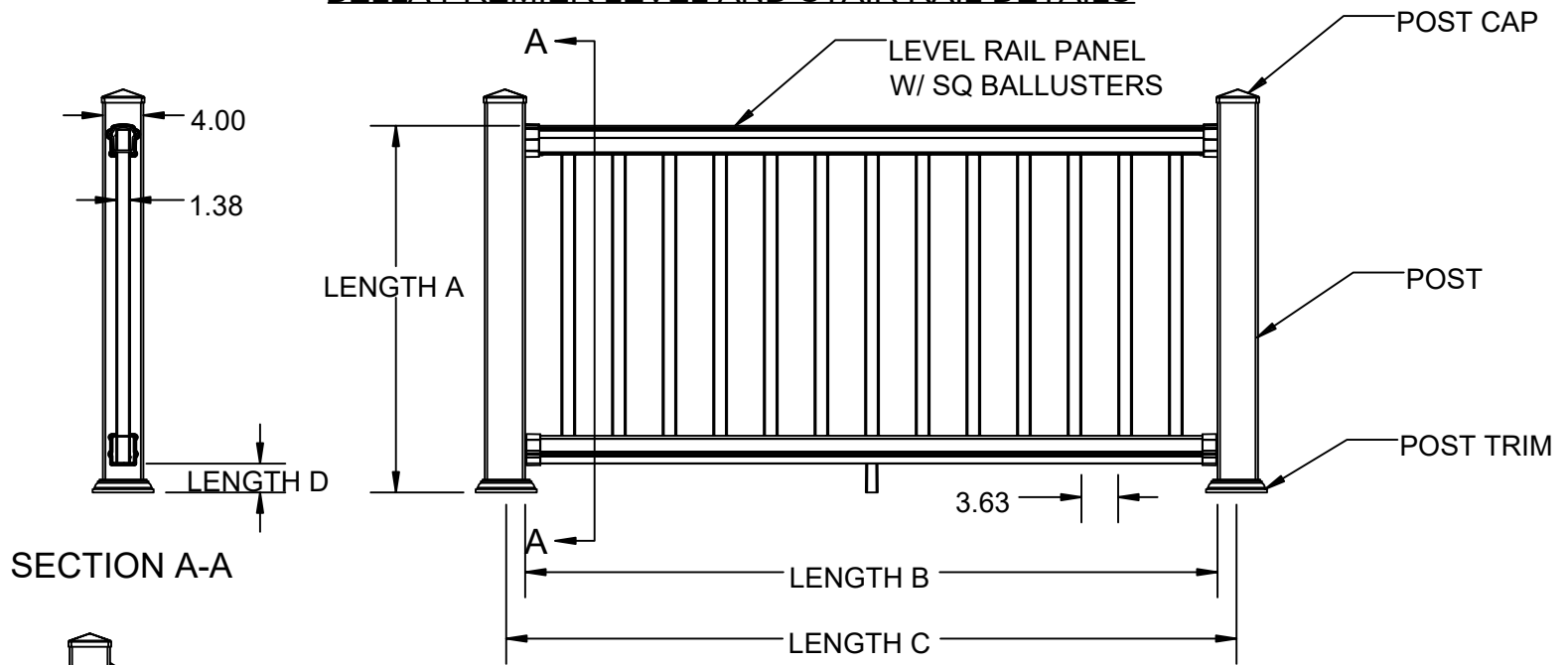

NOTE:  
 (A) FINISHED RAIL HEIGHT = 36", 42" (SQ BALLUSTERS ONLY)  
 (B) PANEL LENGTH = 67.125", 91.125", 115.125"  
 (C) MAX SPANS = 115" (36" HIGH, IRC), 91" (42" HIGH, IBC)  
 (D) BOTTOM SPACE = 3"

THE INFORMATION CONTAINED IN THIS DRAWING IS PROTECTED BY COPYRIGHT AND PATENT LAWS OF THE UNITED STATES AND OTHER COUNTRIES. ANY REPRODUCTION IN PART OR AS A WHOLE WITHOUT WRITTEN PERMISSION IS PROHIBITED.

<b>rdi</b> RAILING		
DRAWN: CH	DATE: 11/15/2021	APPROVED:
DESCRIPTION: <b>BELLA PREMIER LEVEL AND STAIR RAIL</b>		
SHEET 1 OF 3	REVISION	PART NUMBER
SCALE 1:20	0	<b>N/A</b>
WEIGHT: N/A		

## TOP AND BOTTOM RAIL

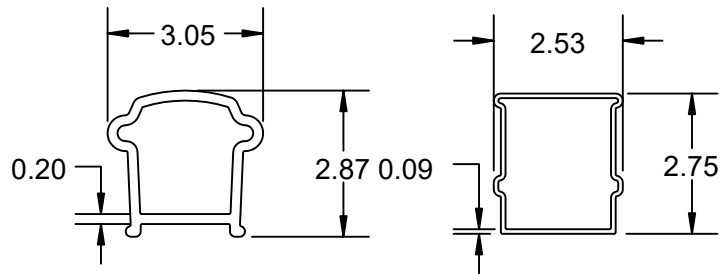

TOP RAIL

BOTTOM RAIL

## STIFFENER

NOTE: STIFFENER ONLY  
PRESENT IN 8' AND 10' PANELS.  
SEE PFS TECO RESEARCH  
REPORT 0101.

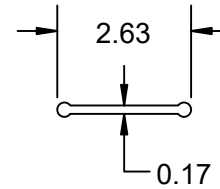

TOP RAIL  
STIFFENER

## ACCESSORIES

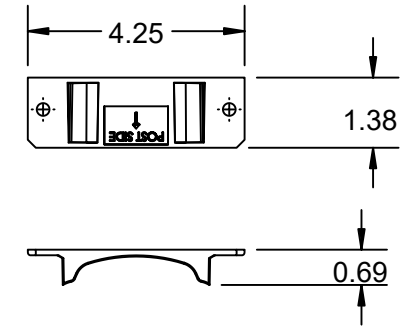

DECK TOP ADAPTER

## POST COMPONENTS

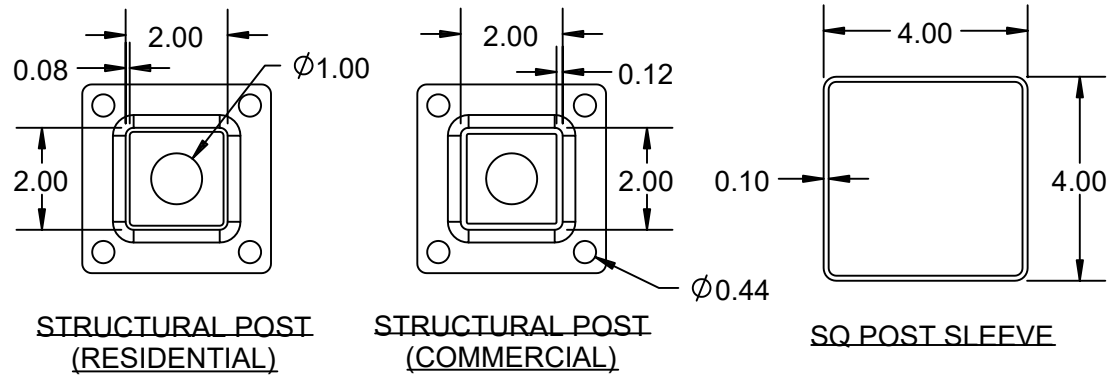

STRUCTURAL POST  
(RESIDENTIAL)

STRUCTURAL POST  
(COMMERCIAL)

SQ POST SLEEVE

## BALUSTERS

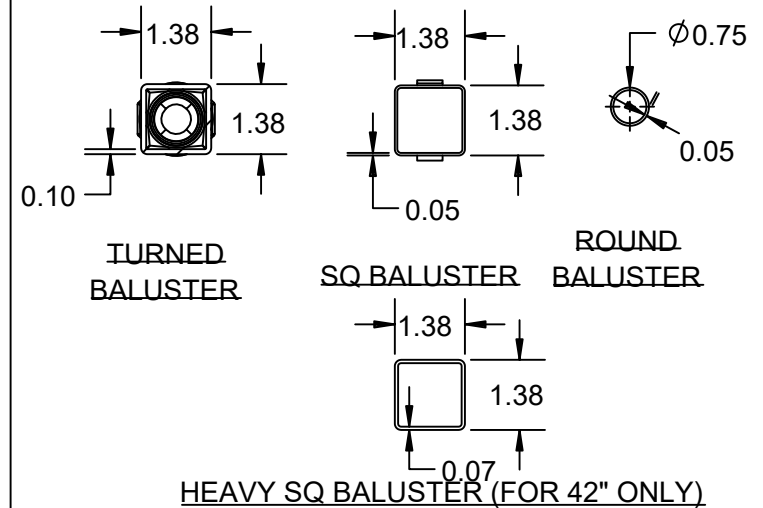

TURNED  
BALUSTER

SQ BALUSTER

ROUND  
BALUSTER

HEAVY SQ BALUSTER (FOR 42" ONLY)

**rdi**  
RAILING

DRAWN:	CH	DATE:	11/15/2021	APPROVED:	
DESCRIPTION: <b>BELLA PREMIER PROFILE DETAILS</b>					
SHEET 2 OF 3		REVISION	PART NUMBER		
SCALE 1:4			N/A		
WEIGHT: N/A					

THE INFORMATION CONTAINED IN THIS DRAWING IS PROTECTED BY COPYRIGHT AND PATENT LAWS OF THE UNITED STATES AND OTHER COUNTRIES. ANY REPRODUCTION IN PART OR AS A WHOLE WITHOUT WRITTEN PERMISSION IS PROHIBITED.

# BELLA PREMIER POST AND MOUNT DETAILS

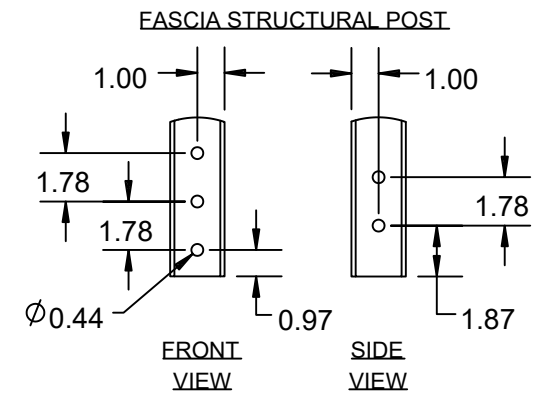
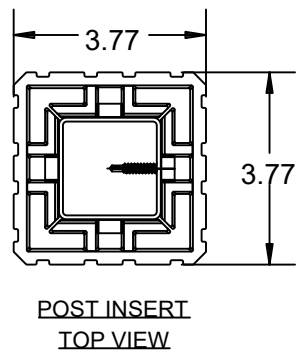
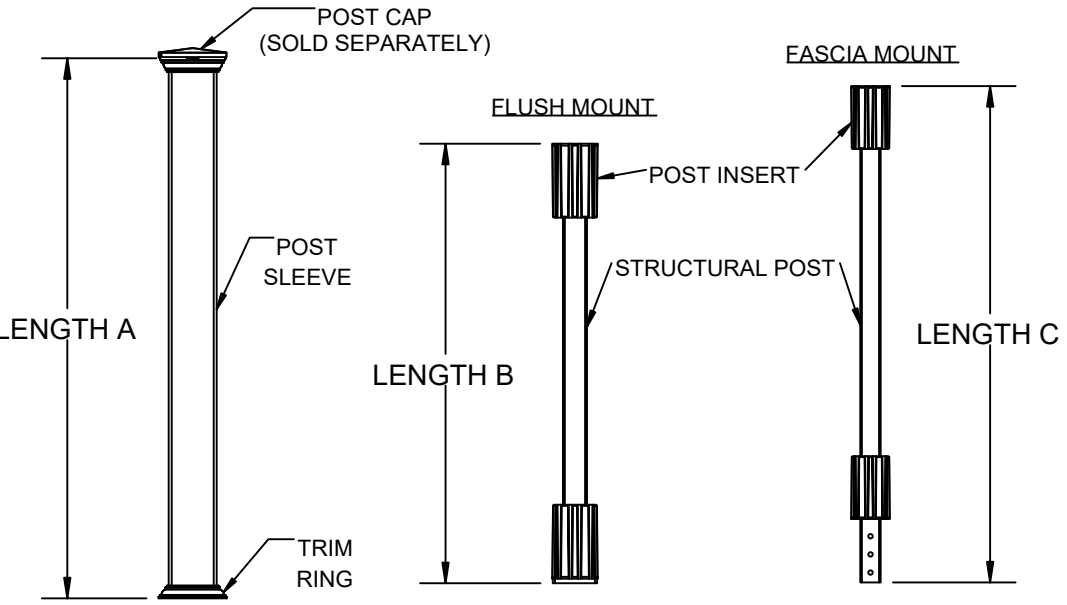

NOTE:  
 (A) = 39", 45", 54", 100", 108", 120"  
 (B) = 36.625", 42.625"  
 (C) = 42.625", 48.625"

## POST BASE CONNECTION INTO CONCRETE W/ WEDGE ANCHORS

## POST BASE CONNECTIONS INTO WOOD WITH THRU BOLTS

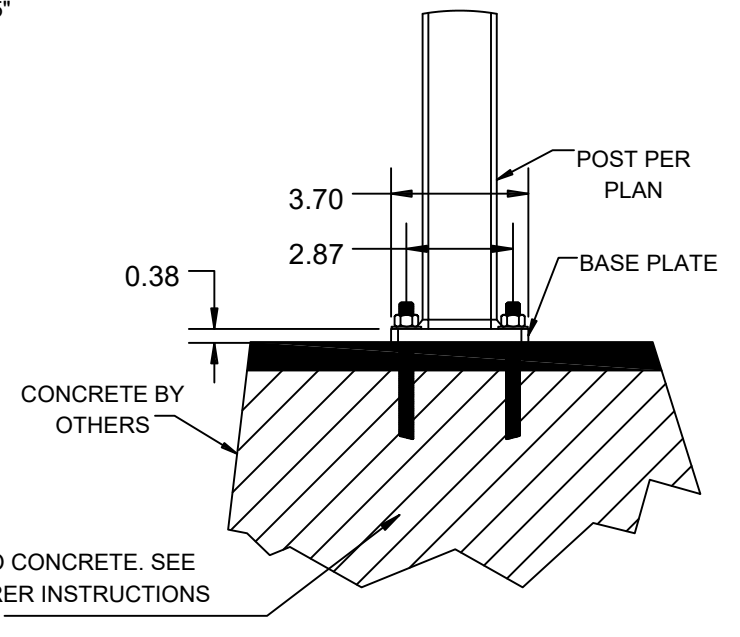
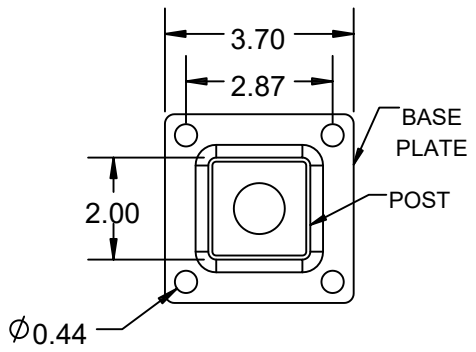
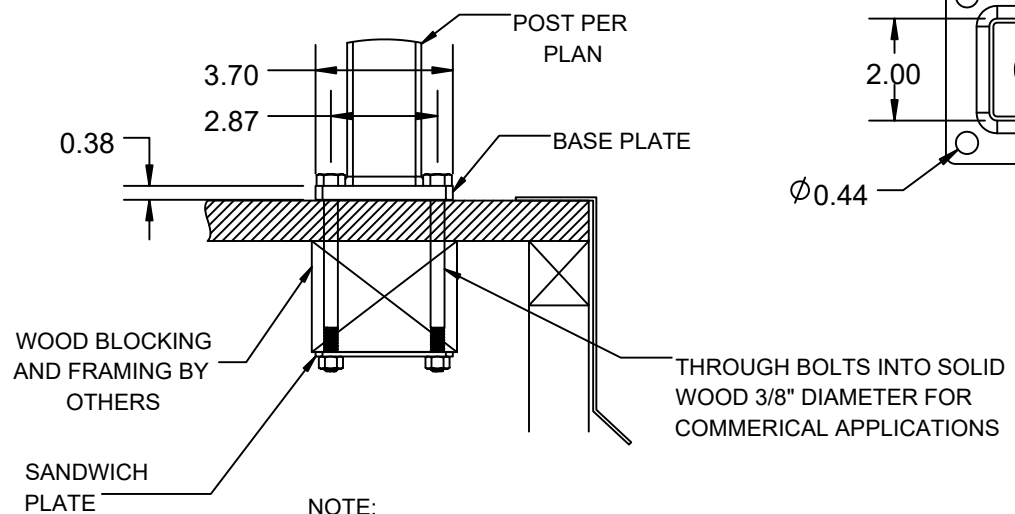

NOTE:  
 1. COMMERCIAL APPLICATIONS ARE ALWAYS BOLTED, USE 3/8" DIAMETER A307 THROUGH BOLTS (MIN 5" LENGTH) INTO SOLID WOOD BLOCKING (MIN 4" EMBEDMENT DEPTH).  
 2. WOOD BLOCKING BY OTHERS.  
 3. BLOCKING MUST BE DESIGNED TO WITHSTAND PROPER LOADING.

THE INFORMATION CONTAINED IN THIS DRAWING IS PROTECTED BY COPYRIGHT AND PATENT LAWS OF THE UNITED STATES AND OTHER COUNTRIES. ANY REPRODUCTION IN PART OR AS A WHOLE WITHOUT WRITTEN PERMISSION IS PROHIBITED.

<b>TOLERANCES</b>		<b>rdi</b> RAILING	
FRACTION ±	/16	DRAWN: CH	DATE: 6/7/2021
XX	±0.01	APPROVED:	
XXX	±0.005	DESCRIPTION: <b>BELLA PREMIER POST &amp; MOUNT DETAILS</b>	
ANGLE	±1.0°	SHEET 3 OF 3	REVISION
FINISH	125 RMS	SCALE 1:15	PART NUMBER
UNLESS OTHERWISE SPECIFIED		WEIGHT: N/A	<b>N/A</b>