

# TRANSFORM LEVEL AND STAIR RAIL DETAILS

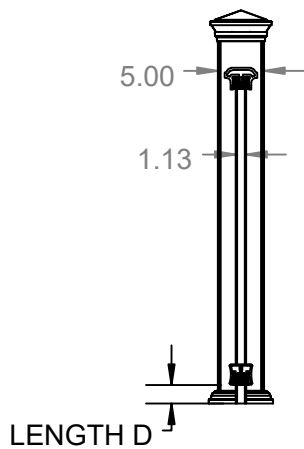

SECTION Z-Z  
SCALE 1 : 22

NOTE:  
 (A) FINISHED RAIL HEIGHT = 36", 42"  
 (B) PANEL LENGTH = 71.75", 95.75"  
 (C) MAX SPANS = 98.5X36" IRC, 98.5X42" IBC  
 (D) BOTTOM SPACE = 2" - 4"

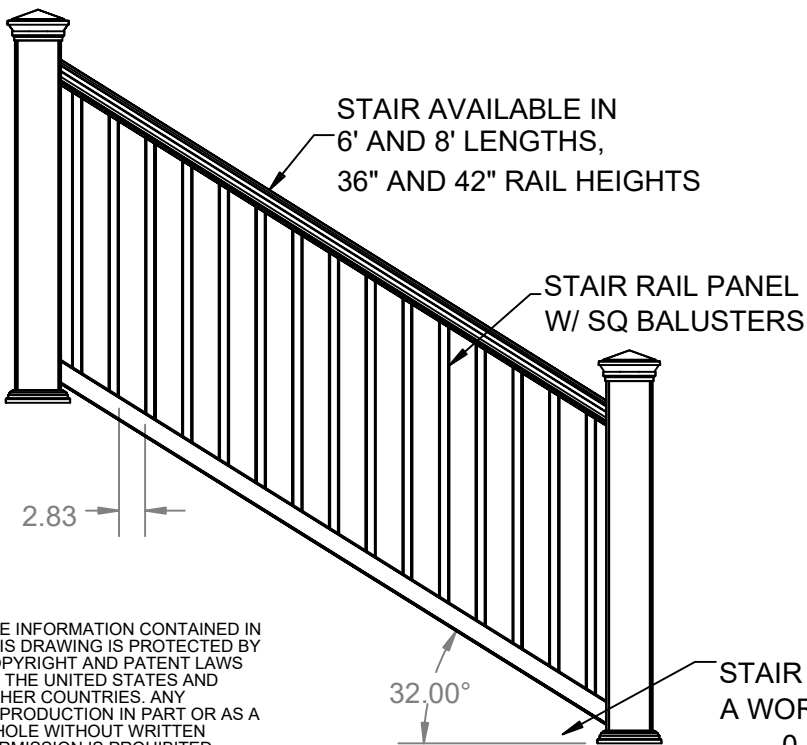
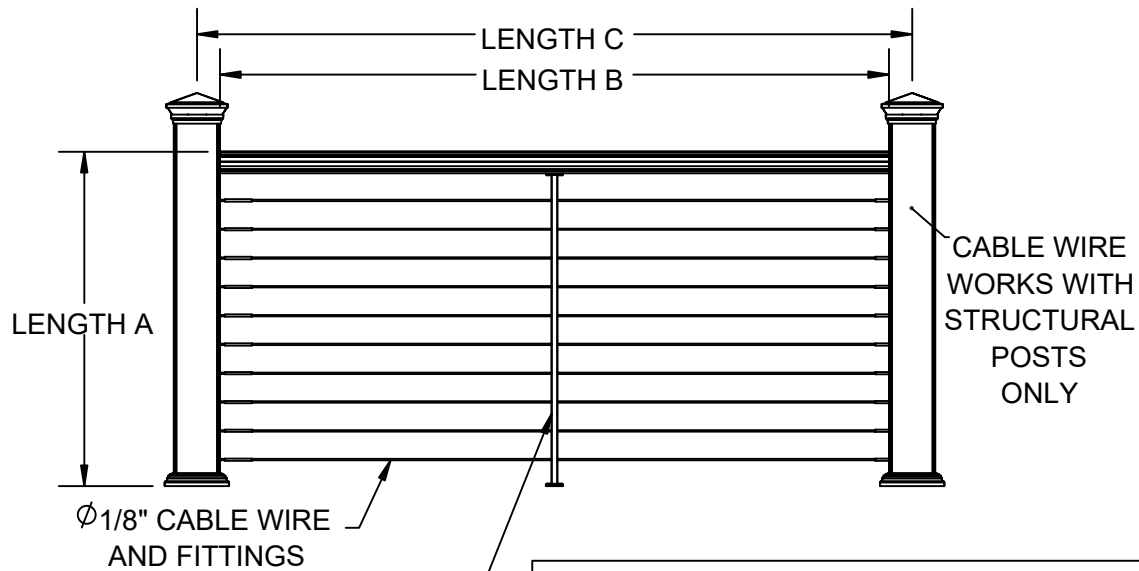
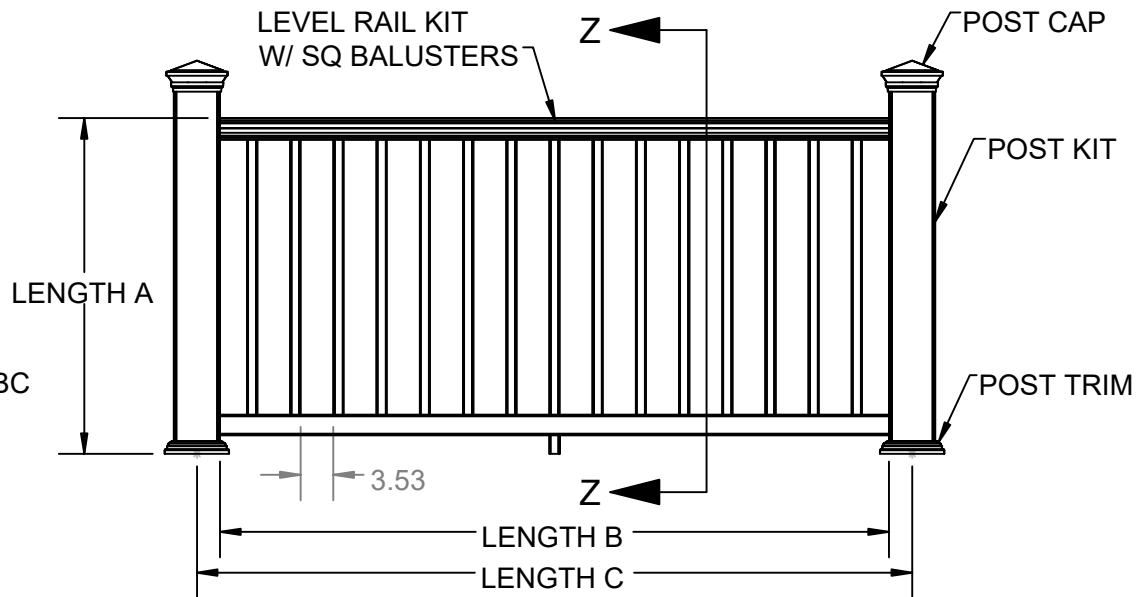

DRAWN: RP	DATE: 04/24/2018	APPROVED:
DESCRIPTION: <b>TRANSFORM LEVEL AND STAIR RAIL</b>		
SHEET 1 OF 3	REVISION	PART NUMBER
SCALE 1:22		N/A
WEIGHT: N/A		

THE INFORMATION CONTAINED IN THIS DRAWING IS PROTECTED BY COPYRIGHT AND PATENT LAWS OF THE UNITED STATES AND OTHER COUNTRIES. ANY REPRODUCTION IN PART OR AS A WHOLE WITHOUT WRITTEN PERMISSION IS PROHIBITED.

# TRANSFORM POST AND SURFACE MOUNT DETAILS

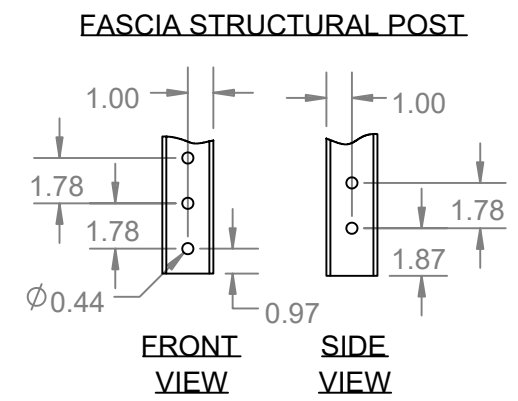
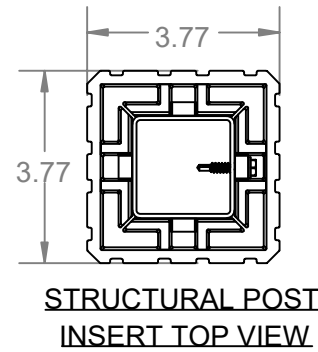
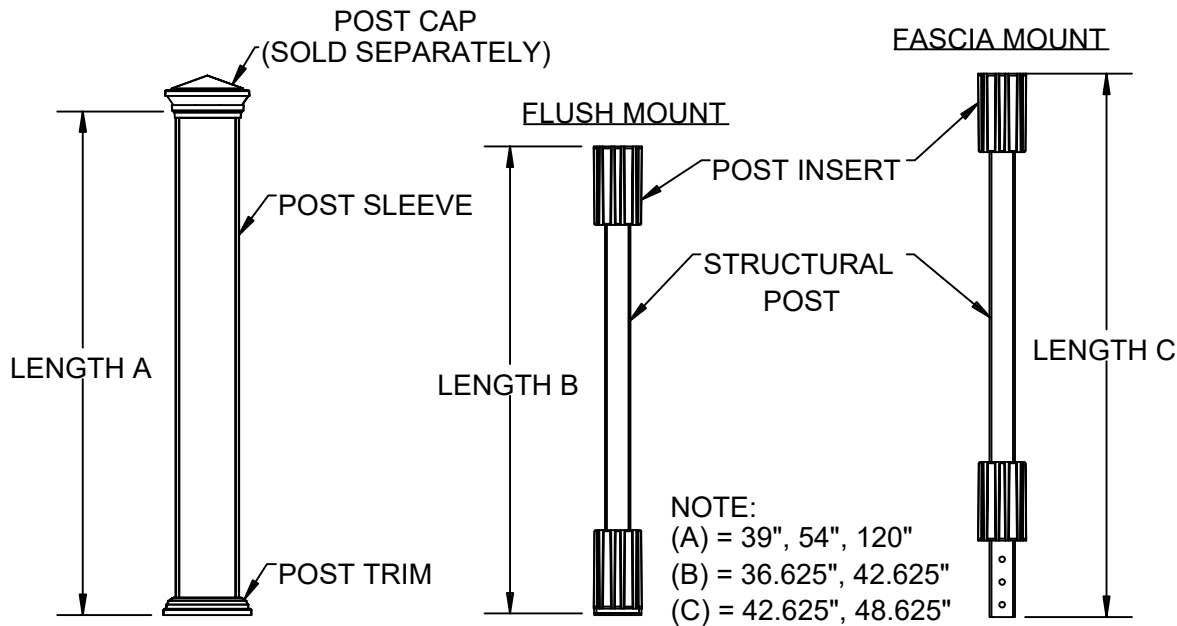

## POST BASE CONNECTION INTO CONCRETE WITH WEDGE ANCHORS

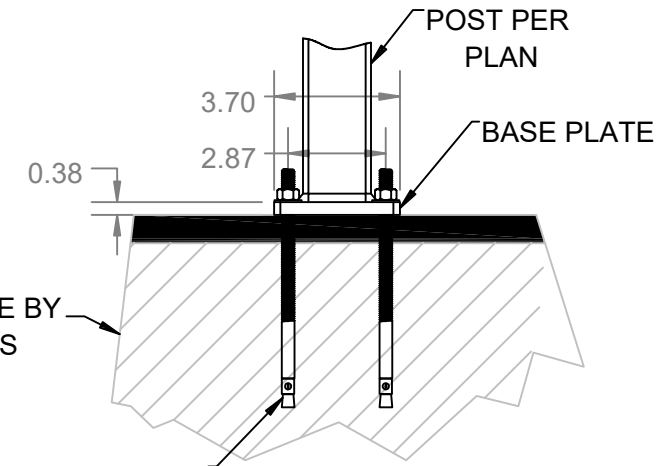

## POST BASE CONNECTION INTO WOOD WITH THRU BOLT

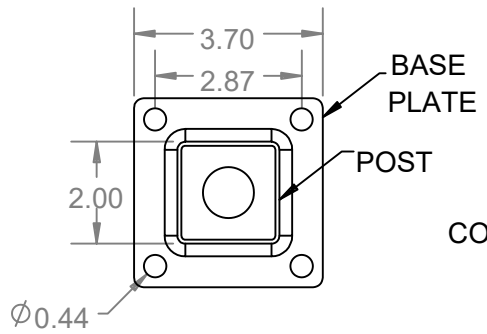
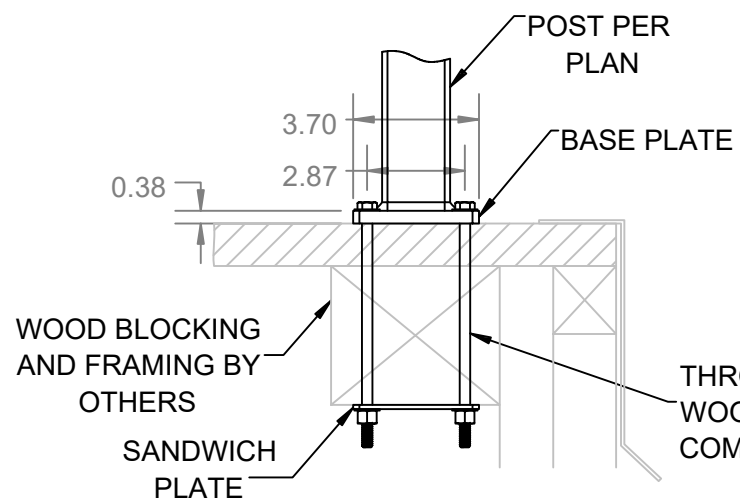

ANCHOR INTO CONCRETE. SEE MANUFACTURER INSTRUCTIONS FOR DETAILS.

THROUGH BOLTS INTO SOLID WOOD 3/8" DIAMETER FOR COMMERCIAL APPLICATIONS

- NOTE:
1. COMMERCIAL APPLICATIONS ARE ALWAYS BOLTED, USE 3/8" DIAMETER A307 THROUGH BOLTS INTO SOLID WOOD BLOCKING.
  2. WOOD BLOCKING BY OTHERS.
  3. BLOCKING MUST BE DESIGNED TO WITHSTAND PROPER LOADING.

THE INFORMATION CONTAINED IN THIS DRAWING IS PROTECTED BY COPYRIGHT AND PATENT LAWS OF THE UNITED STATES AND OTHER COUNTRIES. ANY REPRODUCTION IN PART OR AS A WHOLE WITHOUT WRITTEN PERMISSION IS PROHIBITED.

<b>rdi</b> RAILING		
DRAWN: RP	DATE: 04/24/2018	APPROVED:
DESCRIPTION <b>TRANSFORM POST AND SURFACE MOUNT DETAILS</b>		
SHEET 3 OF 3	REVISION	PART NUMBER
SCALE 1:16	0	N/A
WEIGHT: N/A		

## TOP AND BOTTOM RAIL

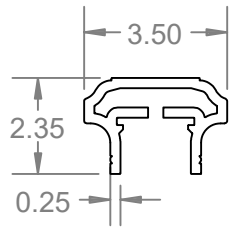

**TOP RAIL  
ASPIRE**

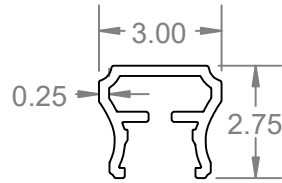

**TOP RAIL  
EMERGE**

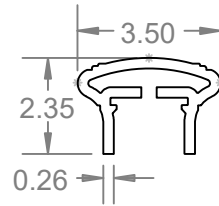

**TOP RAIL  
PRESENCE**

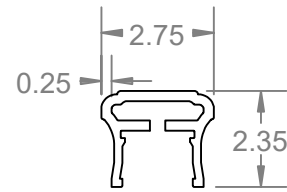

**TOP RAIL  
GRASPABLE  
(STAIR ONLY)**

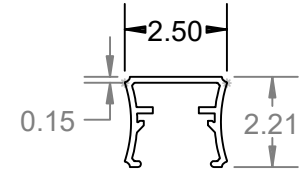

**BOTTOM RAIL**

## POST COMPONENTS

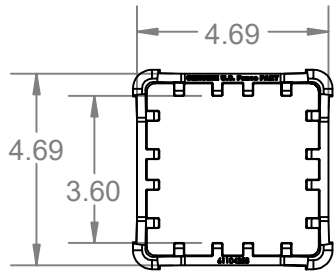

**POST SLEEVE INSERT  
(INCLUDED W/ SLEEVE)**

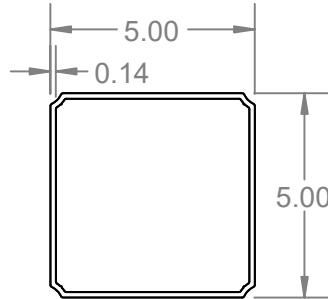

**POST SLEEVE**

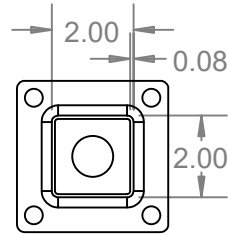

**STRUCTURAL POST  
(RESIDENTIAL)**

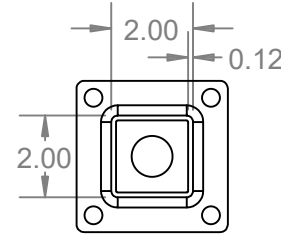

**STRUCTURAL POST  
(COMMERCIAL)**

## BALUSTERS

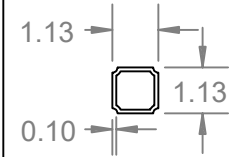

**SQ BALUSTER**

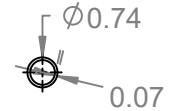

**ROUND  
BALUSTER**



**CABLE  
WIRE**

NOTE: POST SLEEVE INSERT ALIGNS WITH GROOVE ON STRUCTURAL POST INSERT TO WORK WITH 5X5 SLEEVE.



DRAWN:	RP	DATE:	04/24/2018	APPROVED:	
DESCRIPTION: <b>TRANSFORM RAIL PROFILES &amp; INFILL DETAILS</b>					
SHEET 2 OF 3		REVISION		PART NUMBER	
SCALE 1:5		0		<b>N/A</b>	
WEIGHT: N/A					

THE INFORMATION CONTAINED IN THIS DRAWING IS PROTECTED BY COPYRIGHT AND PATENT LAWS OF THE UNITED STATES AND OTHER COUNTRIES. ANY REPRODUCTION IN PART OR AS A WHOLE WITHOUT WRITTEN PERMISSION IS PROHIBITED.